

## Somerset House Lower Middle Street, Taunton, Somerset, TA1

Sold @ Auction £152,000



- FOR SALE BY ONLINE AUCTION
- WEDNESDAY 18TH JUNE 2025
- VIEWINGS – REFER TO DETAILS
- DOWNLOAD FREE LEGAL PACK
- VIRTUAL TOUR NOW ONLINE
- SOLD @ JUNE LIVE ONLINE AUCTION
- FREEHOLD COMMERCIAL
- VACANT OFFICE BUILDING
- SCOPE FOR RESI CONVERSION STC
- EXTENDED 8 WEEK COMPLETION

Hollis Morgan – JUNE LIVE ONLINE AUCTION – A Freehold Grade II Listed VACANT OFFICE BUILDING ( 1201 Sq Ft ) with scope for RESI CONVERSION subject to consents.

# Somerset House Lower Middle Street, Taunton, Somerset, TA1 1SF

## Accommodation

### FOR SALE BY LIVE ONLINE AUCTION

\*\*\* SOLD @ JUNE LIVE ONLINE AUCTION \*\*\*

GUIDE PRICE £125,000 +++  
SOLD @ £152,000

ADDRESS | Somerset House, Lower Middle St, Taunton, TA1 1SF

Lot Number 12

The Live Online Auction is on Wednesday 18th June 2025 @ 17:30  
Registration Deadline is on Monday 16th June 2025 @ 16:00

The Auction will be streamed LIVE ONLINE via the Hollis Morgan website & you can chose to bid by telephone, proxy or via your computer. Registration is a simple online process – please visit the Hollis Morgan auction website and click "REGISTER TO BID"

### GUIDE PRICE RANGE

The vendors have issued a guide price range of £125,000 - £150,000 for this lot.

### THE PROPERTY

Somerset House is an imposing end of terrace property with accommodation ( 1201 Sq Ft ) arranged over two floors that has been most recently occupied as offices but now offered with vacant possession.

Tenure - Freehold

VAT - Please note the property is VAT registered.

EPC - D

### THE OPPORTUNITY

COMMERCIAL INVESTMENT

The property is offered with vacant possession in good decorative order and would suit immediate occupation for commercial tenants or owner occupiers.

### RESIDENTIAL DEVELOPMENT

The property has scope for residential conversion to either flats or a single dwelling / HMO subject to gaining the necessary consents. We understand no planning of this nature has been recently sought. Interested parties to make their own investigations.

### LOCATION

The property is located on Lower Middle Street a popular thoroughfare in the centre of town close to the Hospital. Taunton is the county town of Somerset with a population of approximately 75,000 people, a strong office based economy and a busy town centre, boasting numerous retailers and leisure occupiers, with significant developments to improve the town currently taking place. Taunton provides an extensive range of facilities and also has access to the M5 motorway, there is a main line city rail link which is easily accessible, London Paddington being about 2

## Floor plan

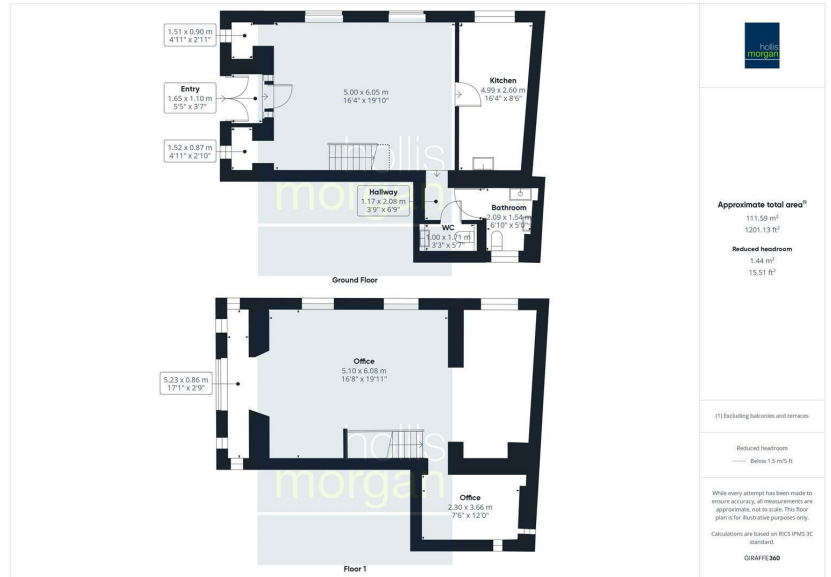

## EPC Chart

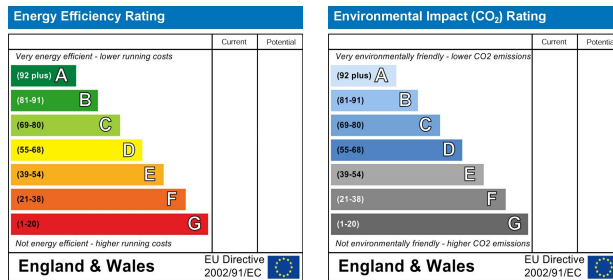

9 Waterloo Street  
Clifton  
Bristol  
BS8 4BT

Tel: 0117 973 6565  
Email: post@hollismorgan.co.uk  
www.hollismorgan.co.uk

Hollis Morgan Property Limited, registered in England, registered 7275716.  
Registered address, 5 Upper Belgrave Road, Clifton, Bristol BS8 2XQ

## Auction Property Details Disclaimer

Hollis Morgan endeavour to make our sales details clear, accurate and reliable in line with the Consumer Protection from Unfair Trading Regulations 2008 but they should not be relied on as statements or representations of fact.

Please refer to our website for further details.